

patents pending

Applications

- Ultra Shallow Water
- Cable / Pipeline / Umbilical Trenching
- Cable / Pipeline / Umbilical Deburial
- Freespan & Sandwave Clearance
- Backfilling and Burial
- Jack Up Spud Can Clearing & Cleaning
- UXO & Salvage Deburial
- Rock Dump & Drill Cutting Removal
- Harbour Clearance
- Subsea Structure Foundation Access

Capabilities

Max Jet Flow	2,600L/s
Max Jet Pressure	140kPa
Max Jet Power	290kW
Minimum Operating Depth	1m

Services

- Safer non-contact methods
- Jet Trenching
- Controlled & Mass Flow Excavation
- Highly qualified & experienced operators
- Real time sonar monitoring of service
- Rotech Engineering & Fabrication

Personnel

- 6 Rotech operators for 24hr operations
- 2 additional Rotech operators are supplied to operate the jetting system for soils in excess of 140kPa

TRS1-LD Deck Plan

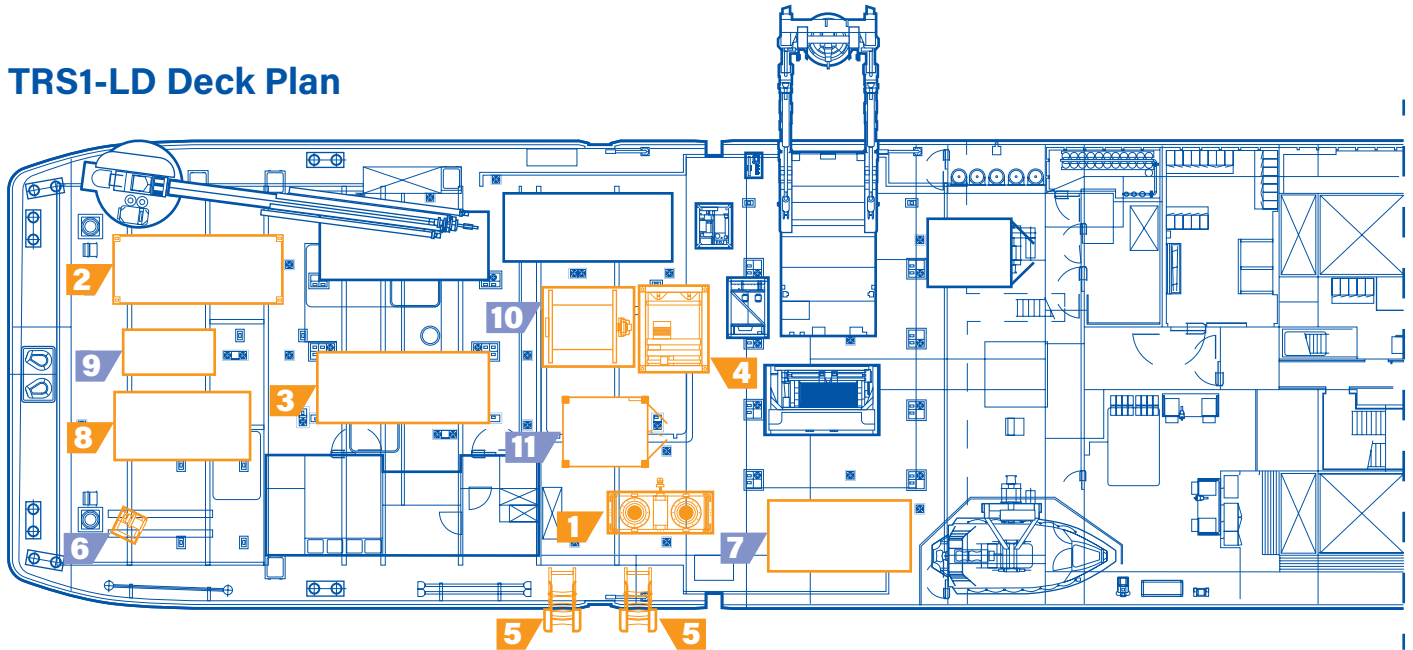

Key

No.	Item	Dimensions (m)	Weight (kg)
1	TRS1 LD Tool	3.95 x 2.39 x 1.59	7,000
2	Tool HPU	6.10 x 2.45 x 2.40	16,000
3	Spares Container (Rotech)	6.10 x 2.45 x 2.70	12,000
4	Hydraulic Umbilical Spooler	2.26 x 2.56 x 2.42	10,000
5	Umbilical Chute	2.90 x 0.84 x 1.17	1,000
6	Deck Tugger (optional)	1.34 x 0.56 x 0.69	1,100
7	Tugger Compressor (optional)	5.02 x 2.45 x 2.51	10,000
8	WP18 Pump (optional)	4.65 x 2.53 x 2.85	8,250
9	LP230 Whisper Lift Pump (optional)	3.33 x 1.61 x 2.45	1,950
10	4" Hose Reeler - Water Jets (optional)	3.3 x 2.87 x 3.05	6,500
11	Control Shack (optional)	3.05 x 2.45 x 2.60	5,000

For over two decades Rotech have pioneered the development of cutting edge subsea controlled flow excavation technology. A dedication to innovation has seen Rotech continually evolve and enhance our specialised equipment to meet demand and deliver for the needs of many major clients in the subsea oil & gas and energy sectors.